

All drawing measurements are approximate.

Note: all load-bearing walls are assumed. Subject to on site inspection and open up works by chosen contractor.

Note: all garden and neighboring property ground levels are approximate. Subject to on site inspection by chosen contractor.

Note: The neighboring property have not been surveyed.

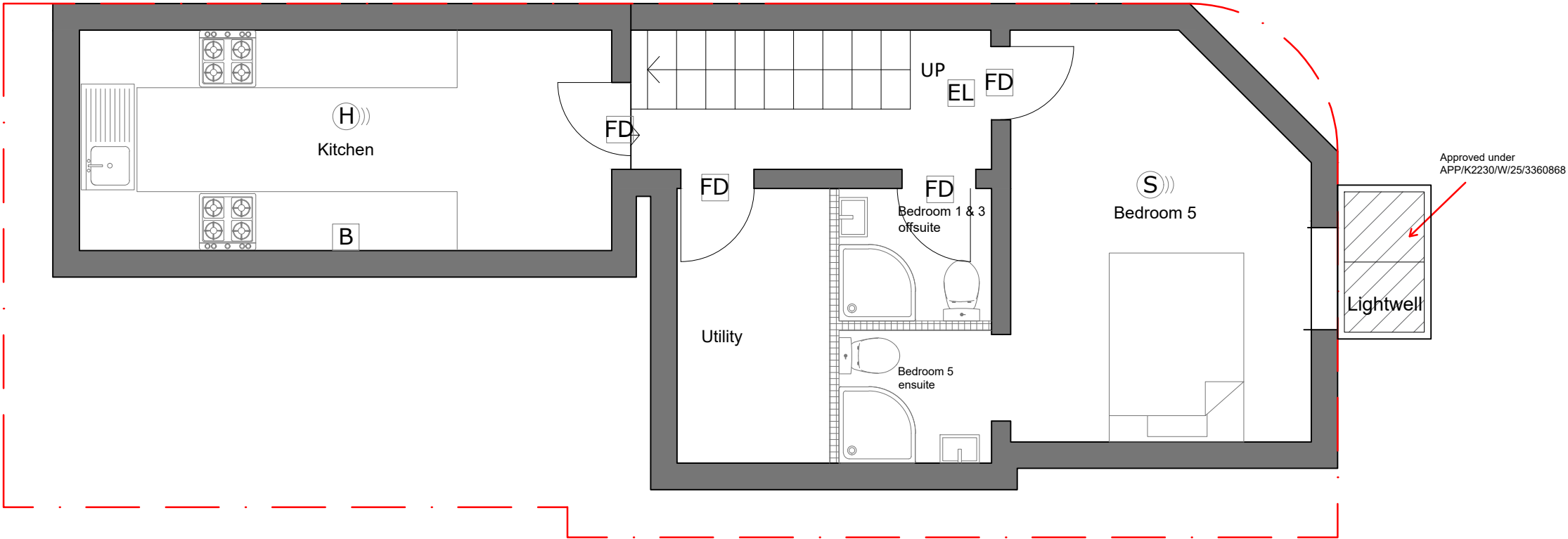

Basement Floor Plan

- KEY
- (S)) - Combined smoke detector & sounder
 - (H)) - Combined heat detector & sounder
 - B - Fire blanket
 - EL - Emergency lighting unit
 - FD - Fire door
 - P - Dry powder fire extinguisher

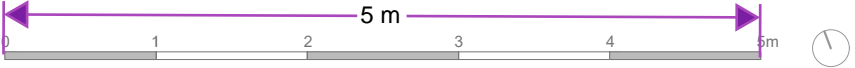

Drawing Information								Revision History		Client & Project Details		Legal & Copyright	
Drawing Number	Rev	Project Number	Date	Sheet By	Checked By	Scale @ Size	Status	REV	DESCRIPTION	INITIALS/		© THIS DRAWING AND CAD DATA THEREIN IS PROTECTED BY COPYRIGHT AND MUST NOT BE COPIED OR REPRODUCED WITHOUT THE WRITTEN CONSENT OF THE CONSULTANT.	
01		01-2407-120	24/07/25	UP	DG	1:50@ A3	HMO					NO DIMENSIONS ARE TO BE SCALED FROM THIS DRAWING. USE FIGURED DIMENSIONS ONLY. ALL DIMENSIONS AND SIZES ARE TO BE CHECKED ON SITE AND ANY DISCREPANCIES REPORTED TO THE CONSULTANT PRIOR TO INITIATION OF ANY WORKS.	
Drawing Title								Job Name		Client Name		4th Floor, The Universal Building 364-366 Kensington High St London, W14 8NS	
Proposed Basement Floor								19 Edwin St, Gravesend DA12 1ED		Aaron		GOGO STUDIO	
								www.gogo-studio.com info@gogo-studio.com 020 3900 3589					